

HEATING

HOT WATER

Water heater with heat pump
300/500 litre “Ducted” monobloc series
Possibility of integration with solar thermal



Certification EN 16147 from a third-party accredited laboratory BUREAU VERITAS.



Anti-legionella cycle

ErP Ready



HWMAS 3200 HEA-2
HWMAS 5400 HEA-2

Main features

Water heater with heat pump, monobloc on base with the possibility of integration with solar thermal

Refrigerant gas R134A.

300 or 500 litre stainless steel tank.

Hot water up to 60° C with the compressor only.

COP 2.74* for the 300 litre model and COP 2.69* for the 500 litre model.

Anti-legionella cycle that can be customized for different needs or can be excluded.

Innovative soft touch control panel to facilitate commissioning, use and maintenance.

* In accordance with EN 16147.

4 installation modes

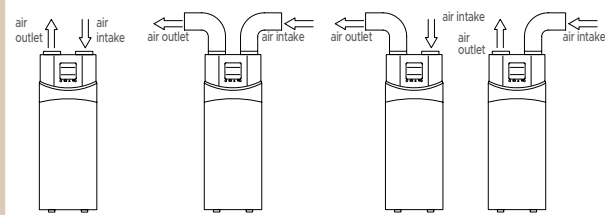

Energy class

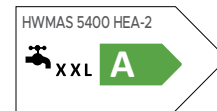
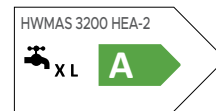

65%
Tax deductions
**Energy
redevelopment**

**THERMAL
ACCOUNT
2.0**

Model		HWMAS 3200 HEA-2	HWMAS 5400 HEA-2
Tank volume	L	300	500
Solar integration coil (stainless steel)	m ²	1.0	1.0
Rated thermal power ¹	W	1840	3700
Rated power consumption ¹	W	533	1093
Rated hot water production capacity ¹	L/h	45	85
COP (rated) ¹	W/W	3.45	3.39
COP _{DHW} ²	W/W	2.74	2.69
Test cycle profile ²	-	XL	XXL
Volume of hot water at 40°C ²	L	351	501
Energy Efficiency Class ³	-	A	A
IP Degree of protection	-	IPX1	IPX1
Hot water T. adjustment interval	°C	10~70 (50 default)	10~70 (50 default)
Maximum DHW temperature only compressor	°C	60	60
Electrical data	Power	-	220-240 Vac / 50 Hz
	Integrative heating element	W	1600
	Maximum current (including heating element)	A	10.0
Refrigerant	Type	-	R134a
	Quantity	kg	0.80
Compressor	-	Rotary (ON/OFF)	Rotary (ON/OFF)
Dimensions	Unit Ø x H	mm	640 x 1845
	Packaging L x D x H	mm	695 x 695 x 1965
Net weight/Gross weight	kg	104/108	122/135
Sound power level	dB(A)	59	60
Sound pressure level at 2 m	dB(A)	46	45
Tank	Tank material	-	Stainless steel
	DHW hydraulic connections	(Inches - DN)	1" - DN25
	Hydraulic solar coil connections	(Inches - DN)	3/4" - DN20
	Magnesium anode	-	G3/4" - Ø 21x300
	Maximum operating pressure	bar	10
	Insulation thickness	mm	45
	Insulation material	-	polyurethane
Suctioned air	Operating range	°C	-5~+43
	Rated flow (not ducted)	m ³ /h	450(@0Pa)
	Air flow (ducted)	m ³ /h	400(@60Pa)
	Air duct - Diameter	mm	177
	Air duct - Length	m	6

Hydraulic connections diagram

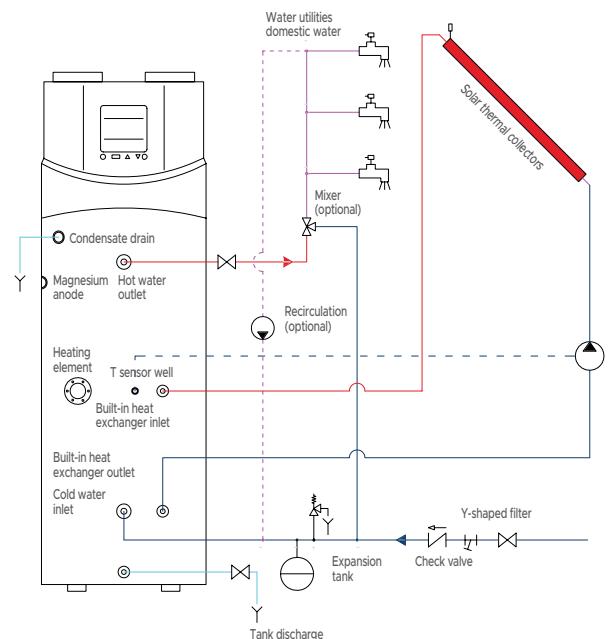

Notes: 1. Conditions: suctioned air 20° C DB (15° C WB), inlet water 15° C / outlet water 55° C. 2. Test according to EN16147; air 20° C. Test according to EN16147; air 7° C. 3. Directive 2009/125/EC - ERP EU no. 814/2013 (WBREAU VERITAS certification).